

⑰ DINETTE WALL

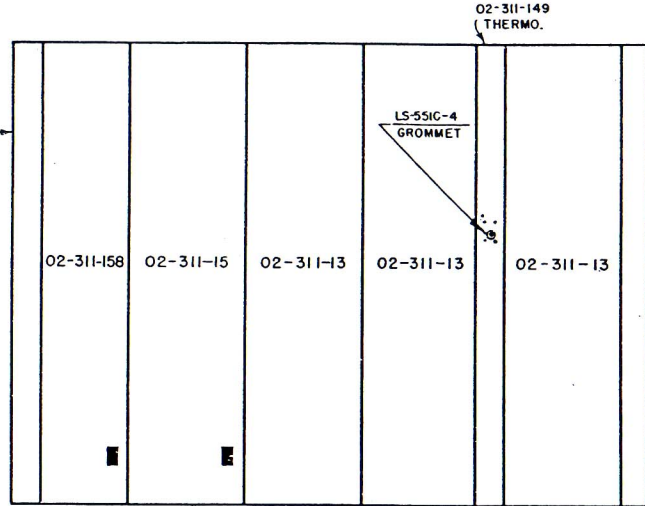

⑱ LIVING ROOM WALL

NOTE:
FOR CORNER PANEL CLIP INSTALLATION AT THIS POINT ONLY SEE EM-02-M-104.I. THESE CLIPS MUST BE INSTALLED BEFORE PANELING IS STARTED.

NOTE:
FOR INSTALLATION OF PENN THERMOSTAT USE (2) TOGGLE BOLTS SUPPLIED WITH THERMOSTAT.
FOR INSTALLATION OF MINN. HONEYWELL USE (3) LS204-6B SELF TAPPING SCREWS.

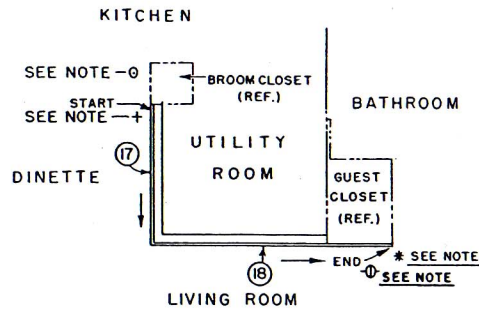

PLAN OF PANEL INSTALLATION PROCEDURE

CAUTION:

CLIPS WHICH HOLD CORNER PANELS MUST BE INSTALLED BEFORE WALL PANELS ARE INSTALLED. SEE EM-02-M-101.I & EM-02-M-101.II FOR INSTALLATION OF THESE CLIPS.

* NOTE:

SEE DWG. EM-02-P-44.I FOR REMAINDER OF PANEL INSTALLATION IN THIS AREA.

⊖ NOTE:

BROOM CLOSET STRUCTURE & PANELLING MUST BE INSTALLED AT THIS POINT.

+ NOTE:

AFTER BROOM CLOSET STRUCTURE AND PANELLING HAVE BEEN INSTALLED CONTINUE WALL PANELLING FROM THIS POINT.

⊖ NOTE:

GUEST CLOSET STRUCTURE & PANELS MUST BE INSTALLED AT THIS POINT.



ERECTION		MANUAL	
TITLE PANELS-INTERIOR WALLS, DINETTE AND LIVING ROOM			
PREPARED BY MWC	DATE 8-15-49	EFF. 1401 THRU 2500 DRAWING NUMBER EM-02-M-71.12	

THIS PAGE SUPERSEDES
EM-02-M-71.1 AT HOUSE
1401.